



TINAJANI

Preliminary Factsheet



Tinajani Canyon

Located along the route connecting Cusco, Puno, and the Colca Valley, Tinajani Canyon is a private nature reserve sculpted by the erosion of an ancient lake that once shaped the Altiplano.

Known as "The Canyon of the Guardians," legend has it that ancient giants were turned to stone by the gods, remaining forever as silent watchers of this mystical landscape.

Rich in history, mythology, and culture, this place, with its almost otherworldly grandeur, immerses you in the majestic stillness of the Andes, leaving you with a profound sense of awe.



Altitude & Climate

At an altitude of over 12,900 ft, Tinajani boasts a unique climate that remains cool and dry for much of the year. The clear skies and pure air make it an ideal destination to enjoy the breathtaking landscape and stargaze on crisp, clear nights.

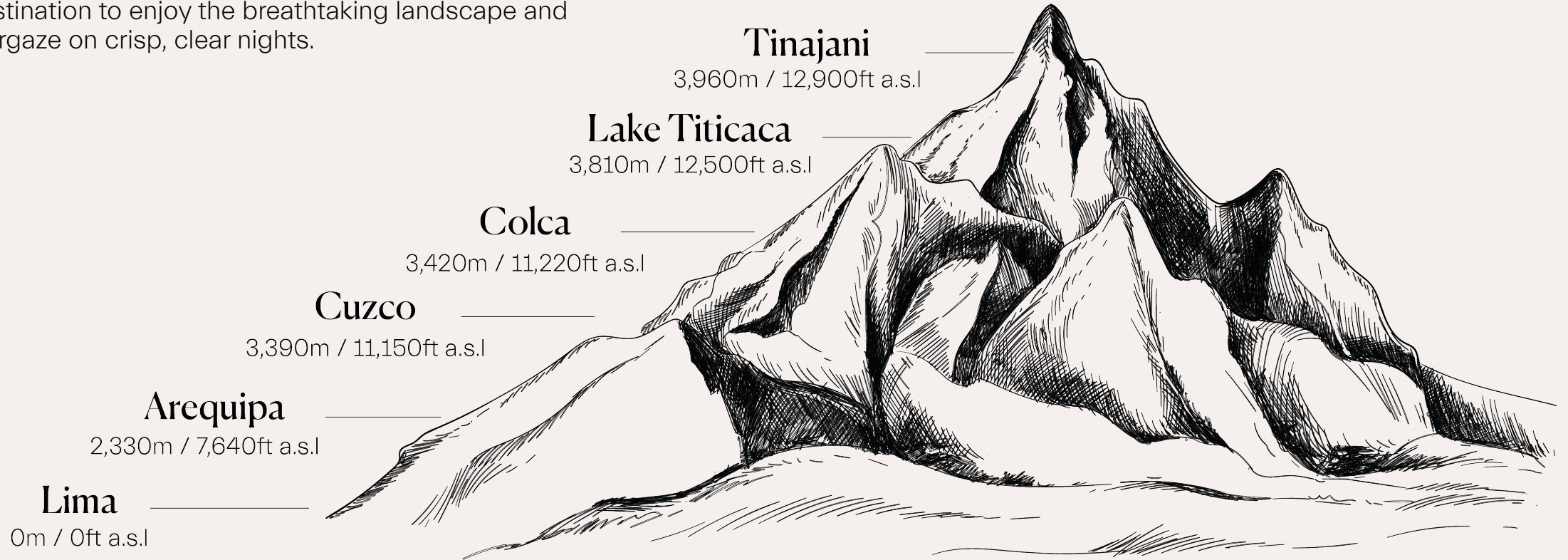

GOLD SEASON

(April - October)



Days: 10°C to 15°C
Nights: 0°C to -10°C

GREEN SEASON

(November - March)



Days: 15°C to 20°C
Nights: 0°C to -5°C





The Hamlet

Tinajani is a secluded hamlet where the vastness of nature embraces you at every turn. The main house is adorned in a rustic, ancient Andean style, evoking a profound sense of place, as though time itself has paused in this hidden corner of the world.

Each camp includes two tents — one for sleeping and another for relaxation — alongside a terrace with a private hot tub and breathtaking views, fostering an intimate connection with the surrounding landscape.

Among streams, picnic spots, and trails leading to hidden viewpoints, this place invites you to lose yourself in the vastness of nature.



Andean



Andean



Andean

fausto

ĀTEMPORAL

CUSCO

TINAJANI

PUQIO

SUASI

TITILAKA

CIRQA

LIMA

CUSCO

COLCA

TINAJANI

LAKE
TITICACA

AREQUIPA



Location



Between Cusco, Puno, and Colca

- 4.5 hrs from Cusco city
- 5 hrs from PUQIO
- 3.5 hrs from Titilaka
- 3 hrs from Suasi

- 2 hours from Juliaca Airport
- 2.5 hours from Puno Train Station



Amenities

- 6 Campamentos
 - Accommodation tent
 - Rest tent
 - Terrace with private hot tub
- Main house (fireplaces, terraces, patios, breakfast areas, picnic spots, bonfires)
- Reception and interpretation centre
- Exploration routes and viewpoints

Services

- In-room check-in
- 24hr concierge & WiFi
- Andean relaxation rituals
- Housekeeping and turndown service
- Shoe cleaning service

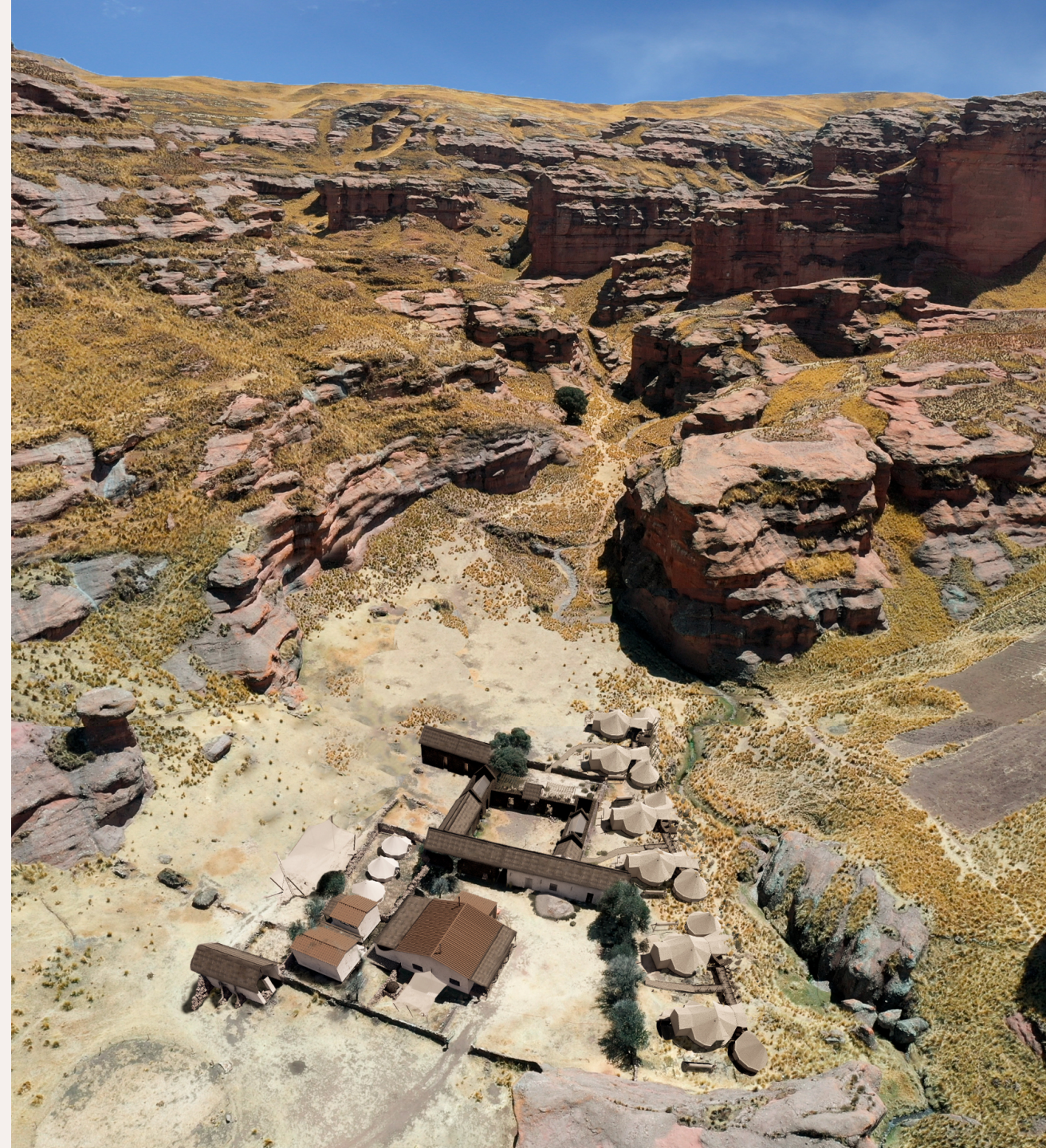



6 Campamentos

1 Campamento

Excursion
Centre & Gear

Reception

Eating Area

Eating
Area

Patio

Mainhouse

Campamentos

Accommodation Tent:

- Twin or king-size beds
- Private bathroom with separate shower
- Organic amenities and toiletries
- Air conditioning with heating and cooling options
- Wardrobes and a safety box

Lounge Tent:

- Double sofa bed
- Wood-burning stove

Terrace:

- Sitting area
- Private hot tub
- Solar-powered hot water system

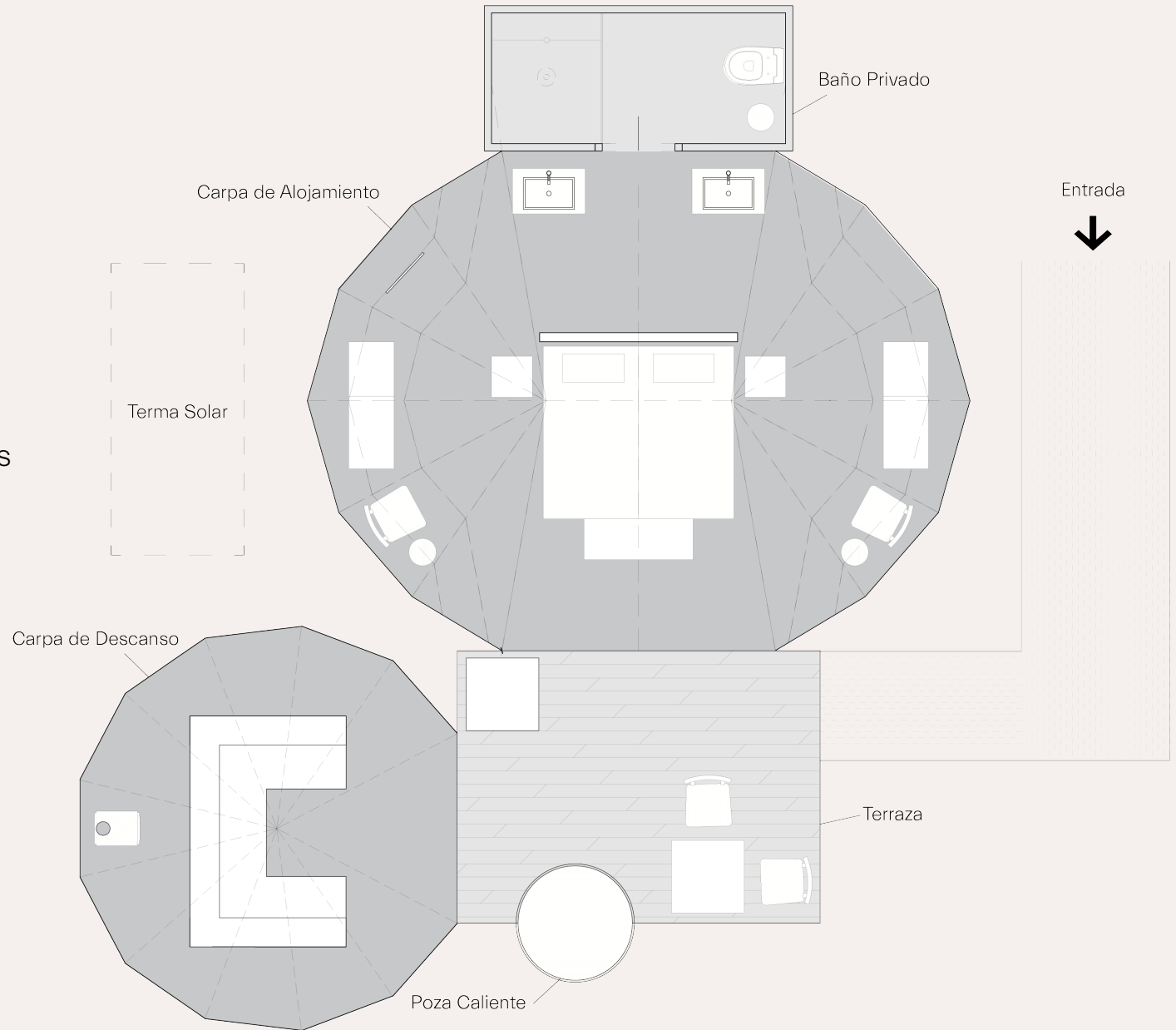



Andean

FOTO REFERENCIAL



Andean

Excursions

Our excursions are designed for those seeking to immerse themselves in the essence of this magical place, inviting them to explore unique landscapes and discover the local history, nature, and culture. Each activity connects you with the beauty and mystery of the region, offering an adventure at your own pace.





What to do?

- Walks and hiking
- Cycling
- Birdwatching
- Stargazing
- Meeting local neighbours
- Visits to artisan workshops

What to see?

- Panoramic views
- Archaeology and geography
- Rock paintings
- Flora and fauna

Where?

- Tinajani Reserve (150 hectares)
- Puya Forest
- Nearby villages (Pucará, Lampa, Ayaviri)

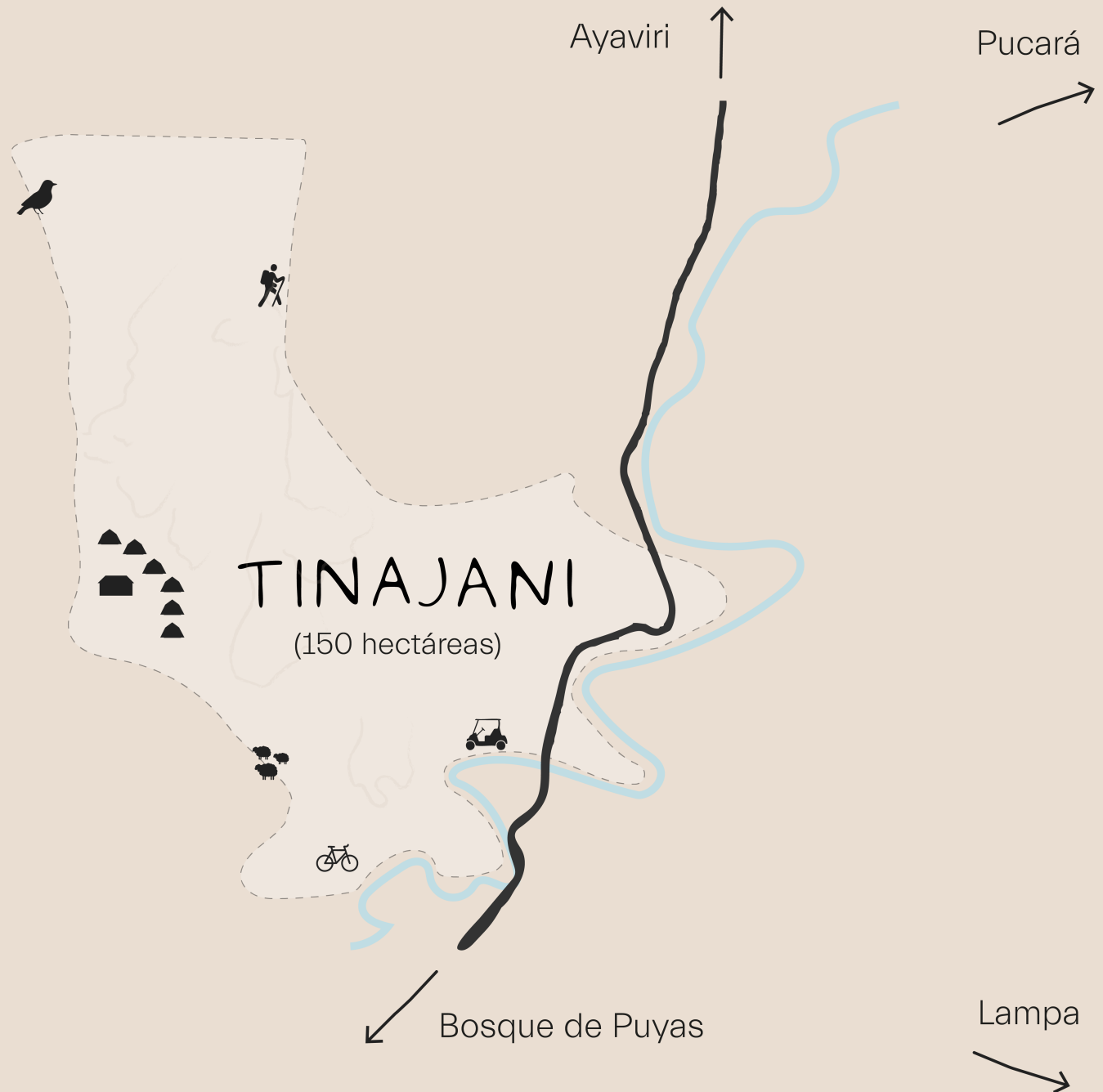

Andean

reservas@andean.travel

[+511 700 5106](tel:+5117005106)

www.andean.travel